

The ECP Integral Tieback System

ECP PPB-350TA is the combination of using the PPB-350 Steel Pier System with TA-150 Helical Tie-back System. In conjunction, they are designed to hold a structure vertically while giving tension support to the pier for open trench excavations. The integral tie-back system can be seen on several projects that need to be held in place while a new construction is taking place next door. This system allows contractors the option to Shotcrete excavated areas as need be.

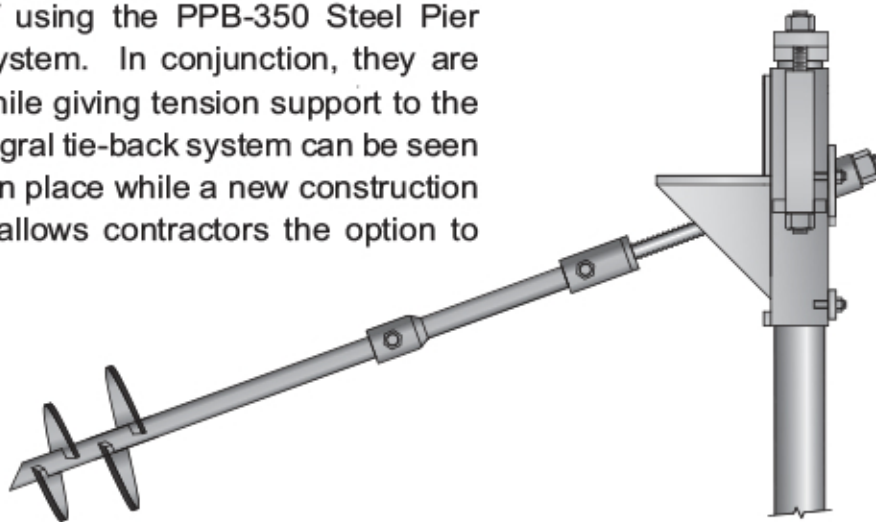

Designed and Engineered to Perform!

What is the order of installation?

First, excavate and prep the foundation footing just like you would for installing ECP PPB-350 Steel Piers. Next, install TA-150 Helical Tieback to required torque. Thirdly, install the ECP PPB-350 to load bearing strata. Finally, attach the PPB-350TA kit. If project requires further excavation, Shotcrete wall may be required as well as more tiebacks. Consult with a Professional Engineer about your specific project.

Note: PPB-350 and TA-150 Helical Tieback are sold separately.

Designed to be the strongest foundation structural support in the industry

- Made of galvanized steel pier material
- Individual and verifiable capacities
- The industry standard in support
- Installs with portable hydraulic equipment
- Designed by engineers

The Engineer's Choice in Quality
Structural Repair Underpinning.



**EARTH
CONTACT
PRODUCTS**

1-866-327-0007

15612 S Keeler Terr.
Olathe, KS 66062
Phone: 913-393-0007
Fax: 913-393-0008
info@getecp.com
www.getecp.com

ECP Steel Pier™ - PPB-350TA Pier System

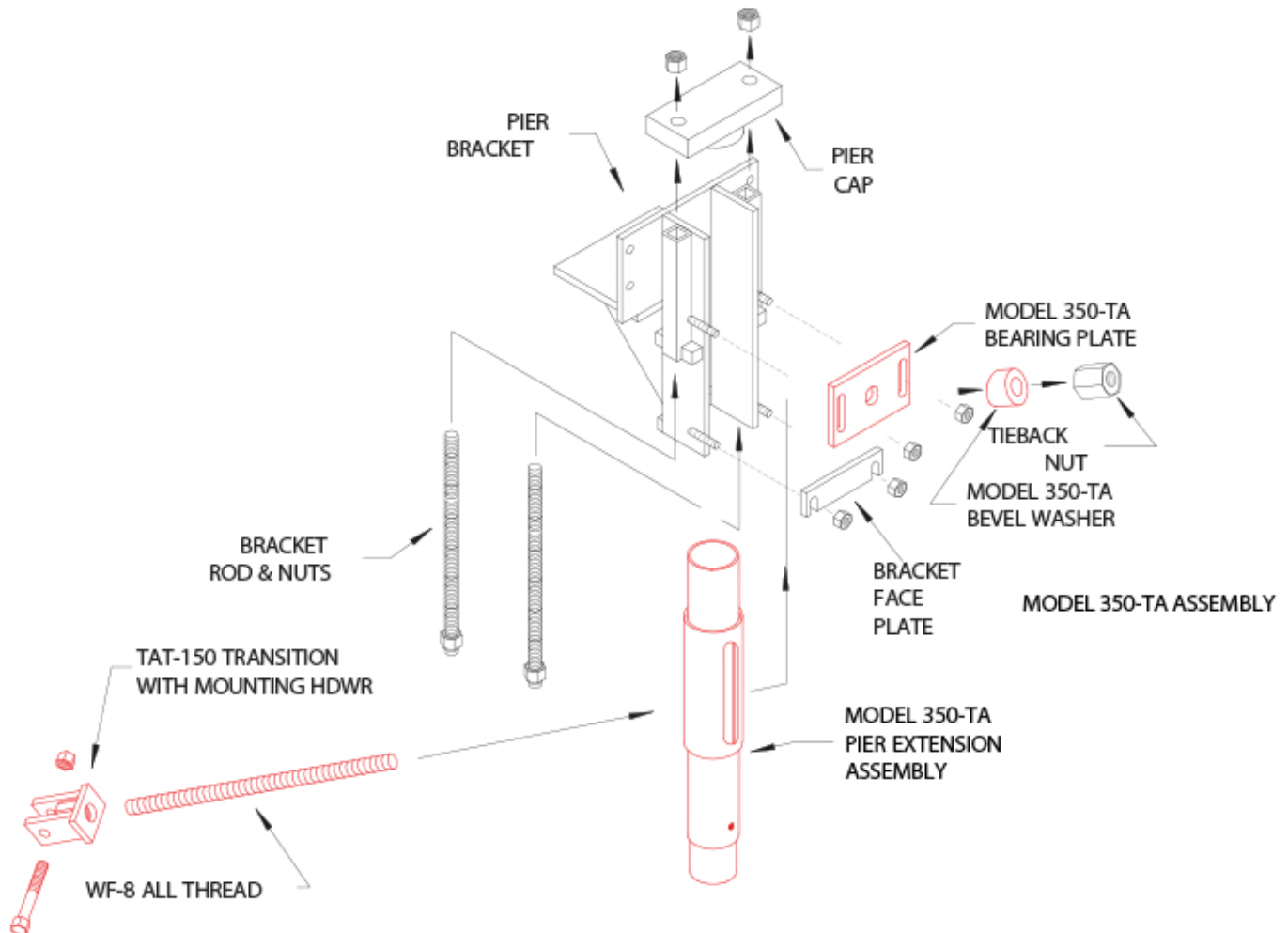

- Model 350 Ultimate Capacity – 86,000 lb.
- Friction Reduction Collar On Starter Section
- 3-1/2" Diameter High Strength, Galvanized Tubular Pier Pipe
- Tubular Pier Pipe Installs To Rock or Verified Load Bearing Stratum
- Installs With Little or No Vibration
- 100% of Piers Proof Tested at Installation
- 1-1/2" Solid Square Shaft Helical Tieback Torque Anchor™ for Lateral Support
- Ultimate Tieback Capacity – 70,000 lb.
- Tieback Installation Angle – 15° to 20°
- Model 350-TA Assembly Required to Connect Bracket to Tieback Anchor
- Manufacturer's Warranty



**EARTH
CONTACT
PRODUCTS**

1-866-327-0007

15612 S Keeler Terr.
Olathe, KS 66062
Phone: 913-393-0007
Fax: 913-393-0008
info@getecp.com
www.getecp.com